

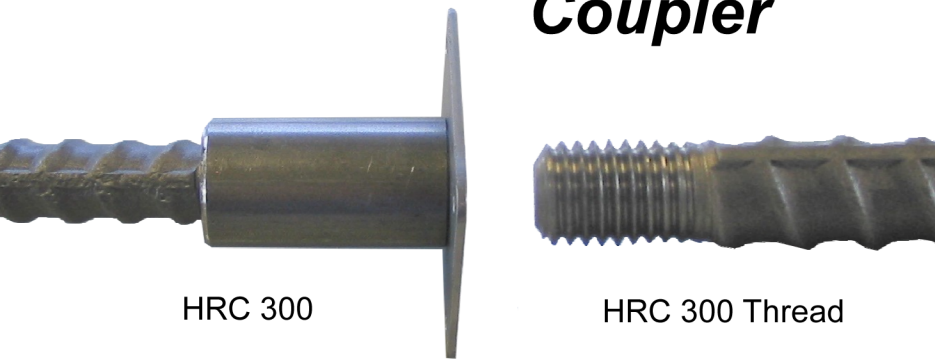

# HRC 300 Series Form Protector Coupler



HRC 300

HRC 300 Thread

**Hand-Tighten to Install**

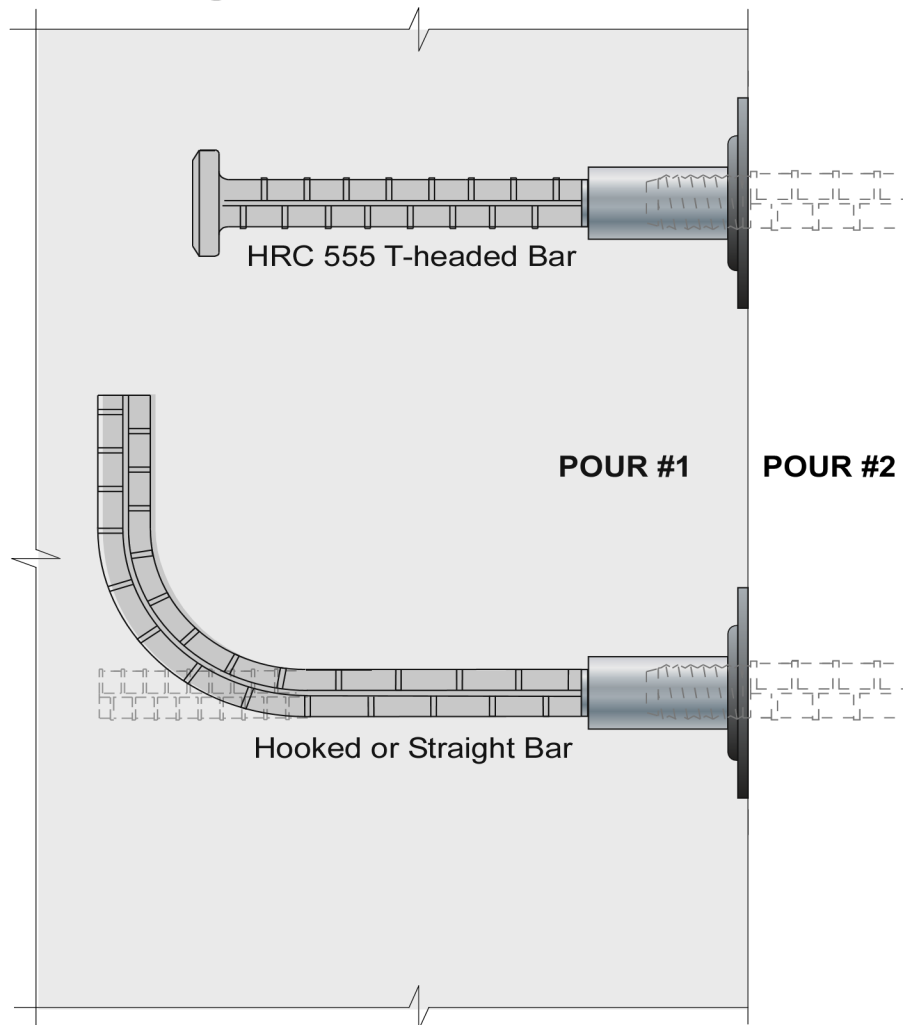

HRC 555 T-headed Bar

POUR #1

POUR #2

Hooked or Straight Bar

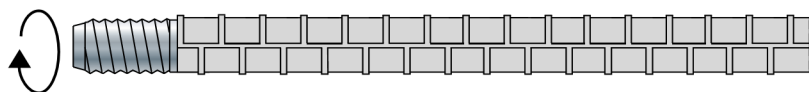

HRC 300 Threaded Bars; Straight or T-headed  
(Standard hooks not recommended for installation)

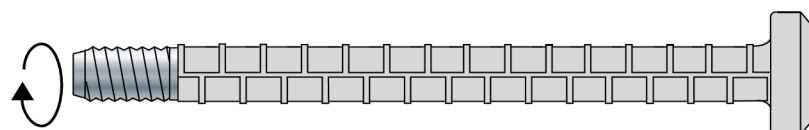

## Mechanical Splicing of Reinforcing Bars

### Applications:

- Construction Joints in Slabs
- Temporary Openings in Slabs
- Stairwell-Wall Joints
- Phased Bridge Construction
- Bridge Slab-Barrier Joints



**Avoids damaging formwork  
Improves constructability**

**HRC Performance  
Local Quality Fabrication**



**Made in the USA**

[sales@hrc-usa.com](mailto:sales@hrc-usa.com)  
(714) 557- 1455  
[www.hrc-usa.com](http://www.hrc-usa.com)

**Headed Reinforcement Corp.**

# HRC 300 Series Form Protector

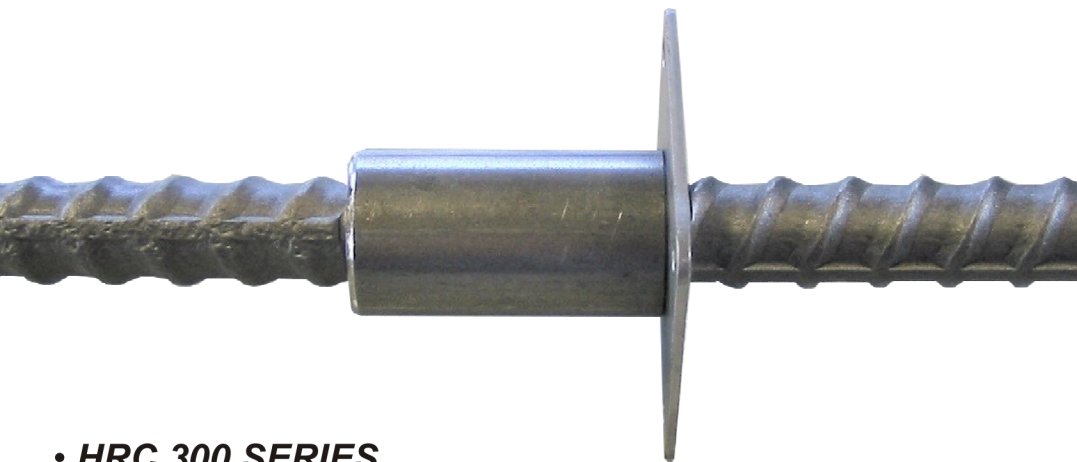

## • HRC 300 SERIES

Headed Reinforcement Corporation introduces the **HRC 300 Series Form Protector**. The **HRC 300 Series** provides an effective alternative to achieve rebar continuity without damaging formwork and improves constructability by reducing transition zone interference when adding headed, hooked or straight dowel bars post pour.

The **HRC 300 Series Form Protector** exceeds Code requirements for Type 1 and Type 2 Splices. When it comes to performance, you can rely on the **HRC 300 Series Form Protector** to outperform dowel bars.

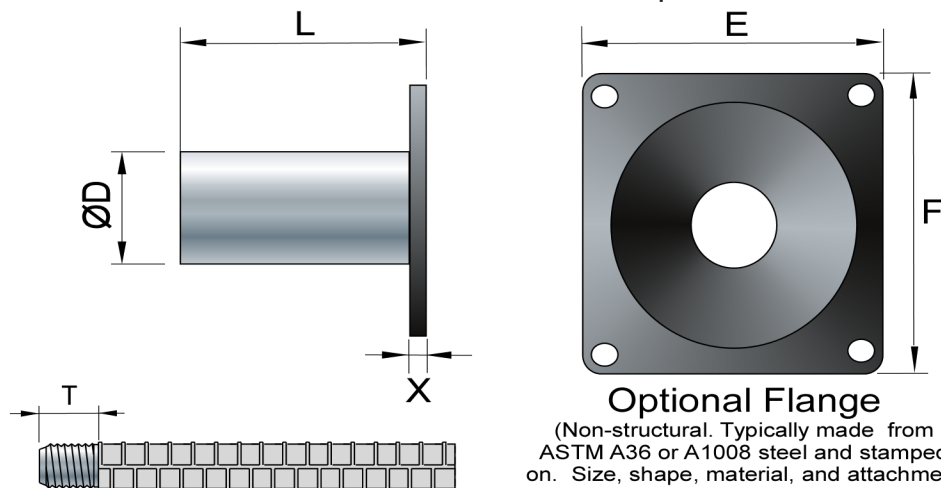

### Optional Flange

(Non-structural. Typically made from ASTM A36 or A1008 steel and stamped on. Size, shape, material, and attachment may vary.)

### Dimensions of HRC 300 Series Form Protector

Bar Size	Thread/Coupler Dimensions				Flange Dimensions	
	Thread Information		Length L (inch)	Diameter D (inch)	Thickness X (inch)	E x F (inch x inch)
	Thread Size (UNC)	T (inch)				
#4	1/2"-13 UNC	0.75	1.75	0.88	0.06	2 x 2
#5 / 15M	5/8"-11 UNC	0.75	2.00	1.00	0.06	2 x 2
#6 / 20M	3/4"-10 UNC	1.00	2.13	1.13	0.06	2 x 2
#7	7/8"-9 UNC	1.00	2.50	1.25	0.06	2 x 2
#8 / 25M	1" -8 UNC	1.125	3.00	1.50	0.04	2.18 x 2.75
#9	1 1/8" -7 UNC	1.625	3.50	1.75	0.06	2.5 x 2.5
#10	1 1/4" -7 UNC	1.75	4.00	2.00	0.06	2.5 x 2.5
#11	M36 x 4	2.00	4.50	2.125	0.06	2.5 x 2.5

Hand-tighten to a snug fit.  
Lubricate threads and use pipe wrench if necessary.

Contact HRC for information on availability for Canadian bar sizes 30M and larger.

Rev. 25-0325



Headed Reinforcement Corp.  
11200 Condor Ave. Fountain Valley, CA 92708  
714-557-1455 714-557-4460 fax

**A615/A706 Grade 60**

**#4 through #11**

**A615/A706 Grade 80**

**#4 through #11**

**Meets or Exceeds Codes and Standards for Splices:**

- ACI 318 Type 1 (125%  $f_y$ ) and Type 2 for ASTM A706/A615 Grade 60
- CSA A23.3 Type 1 (125%  $f_y$ ) and Type 2 for Grades 400R and 400W
- Caltrans Service Splice

### Approvals:

**ICC-ES ESR-2764**

**ICC-ES ESL-1429**

**ACI 318 Compliant**

**CSA A23.3 & S6 Compliant**

**City of Los Angeles  
Building Code (LABC)  
Compliant**

**Caltrans AML  
(Service Splice)**

**Can be used without  
optional flange  
in standard coupler  
applications**

For installation parameters and current approvals please visit [www.hrc-usa.com](http://www.hrc-usa.com) or contact an HRC representative.

